

# Zone Map 444

## - El Paso County -

### Development Services Department



#### Zoning Designations

	RS-20000: Residential Suburban (20,000 sq. ft.)		CN: Commercial Neighborhood
	RS-6000: Residential Suburban (6,000 sq. ft.)		CO: Commercial Office
	RS-5000: Residential Suburban (5,000 sq. ft.)		CC: Commercial Community
	RM-12: Residential Multi-Dwelling (12 DU/acre)		CR: Commercial Regional
	RM-30: Residential Multi-Dwelling (30 DU/acre)		CS: Commercial Service
	RR-0.5: Residential Rural (0.5 acres)		I-1: Research & Development
	RR-2.5: Residential Rural (2.5 acres)		I-2: Limited Industrial
	RR-5: Residential Rural (5 acres)		I-3: Heavy Industrial
	R-T: Residential - Topographic		A-5: Agricultural (5 acres)
	MHP: Mobile Home Park		A-35: Agricultural (35 acres)
	MHP-R: Mobile Home Park, Rural		C-1: ** Commercial
	MHS: Mobile Home Subdivision		C-2: ** Commercial
	RVP: Recreational Vehicle Park		M: ** Industrial
	PUD: Planned Unit Development		R-4: ** Planned Development
	F-5: Forest & Recreation (5 acres)		** Indicates an obsolete designation

#### Supporting Data

	Highways		Section Corner Nodes		Incorporated Cities
	Major Roadways		Sections		Military
	Creeks - Perennial		Parcels		Pike National Forest
	Creeks - Intermittent		Zone Map Boundary		Zoning Overlay
			Special Uses		

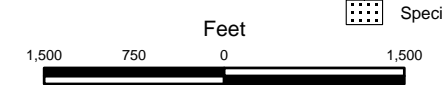

Mar 29, 2007

1 inch equals 1,600 feet

#### Vicinity Map

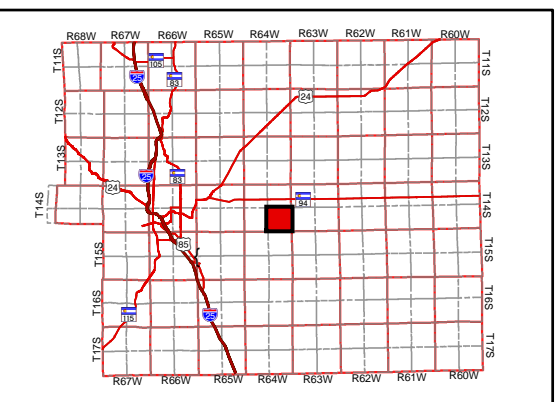

COPYRIGHT 2006 by the Board of County Commissioners, El Paso County, Colorado. All rights reserved. No part of this document or data contained herein may be reproduced; used to prepare derivative products; or distributed without the specific written approval of the Board of County Commissioners, El Paso County, Colorado. This document was prepared from the best data available at the time of plotting and is for internal use only. El Paso County, Colorado, makes no claim as to the completeness or accuracy of the data contained herein.